

## DECLARATION OF PERFORMANCE

NO 1369

24



Unique identification code of product-type: PA33CL100P

Application: Sandwich panels with mineral wool core and sheet metal surface;  
exterior walls, partitions, suspended ceilings

Manufacture name: Isolamin Sweden AB, Industrivägen 5, SE-95632 Överkalix

System: 3

Harmonized standard:-

SP Swedish Testing and Research Institute No. 1002 report 0402-CPD-P605003B

SP Swedish Testing and Research Institute report 99R1 3227 B

Acoustic group Luleå Technical University rapport 961016-06

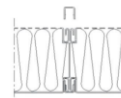
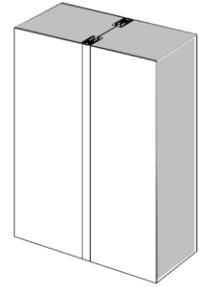

Panel	33CL100P
Thickness	<b>100 mm</b>
Weight	<b>27,6 kg/m<sup>2</sup></b>
Standard widths	<b>565, 1180 mm</b>
U-value	<b>0.47 W/m<sup>2</sup>K</b>

Essential characteristics	Performance	Harmonized technical specification
Tensile strength	<b>NPD</b>	EN 14509:2013
Shear strength	<b>NPD</b>	EN 14509:2013
Sliding Module	<b>NPD</b>	EN 14509:2013
Compressive	<b>NPD</b>	EN 14509:2013
Bending resistance	<b>NPD</b>	EN 14509:2013
Reaction to fire	<b>A2-s1-d0</b>	EN 13501-1:2007
Fire resistance	<b>EI60</b>	EN 13501-2:2016
Fire protection capability	<b>NPD</b>	EN 14509:2013
Thermal resistance	<b>1.96 m<sup>2</sup> K/W</b>	EN 14509:2013
Permeability of water	<b>NPD</b>	EN 12865
Air permeability	<b>NPD</b>	EN 11214
Vapor permeability	<b>NPD</b>	EN 14509:2013
Airborne sound insulation	<b>37 Rw</b>	ISO 140-3:95
Sound absorption	<b>Class A</b>	EN ISO 11654
Dimensional stability	<b>PASS</b>	EN 14509:2013
Durability	<b>PASS</b>	EN 14509:2013

Tolerans	Core material	Surface material
Length: ± 5 mm Width: ± 1 mm Thickness: +0/-1 mm Perpendicularity: 1 mm/m Surface roughness: +0/-0.35 mm	Material: Mineral wool Density: 180 kg/m <sup>3</sup> ±10%	Material: Hot dip galvanized steel sheet Thickness: 0.7/0.7mm Perforering: 23%

Signed on behalf of the manufacturer:

Överkalix 2024-03-04

*Michael Ottesen Fossen*

Michael Ottesen Fossen

Isolamin Sweden AB

R&D Technician / Project coordinator