



## DECLARATION OF PERFORMANCE

NO 1378

24



Product type unique identifier: PA33CL50R2

Application: Sandwich panels with mineral wool core and sheet metal surface;  
exterior walls, partitions, suspended ceilings

Manufacturer name: Isolamin Sweden AB, Industrivägen 5, SE-95632 Överkalix

System: 3

Harmonized standard: EN 14509:2013

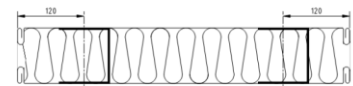
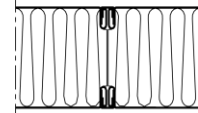
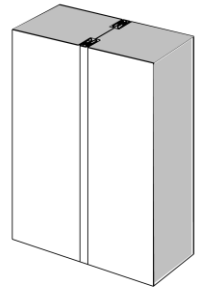
SP Swedish Testing and Research Institute No. 1002 report 0402-CPD-P605003B  
DBI Danish Institute of Fire and Security Technology nr 14095 rapport PCA10104  
SP Swedish Testing and Research Institute No. 1002 report P605204

Panel	33CL50R2
Thickness	50 mm
Weight	22,2 kg/m <sup>2</sup>
Standard widths	565, 1180 mm
U-value	0,89 W/m <sup>2</sup> K

Essential characteristics	Performance	Harmonized technical specification
Tensile strength	NPD	EN 14509:2013
Shear strength	NPD	EN 14509:2013
Sliding Module	NPD	EN 14509:2013
Compressive	NPD	EN 14509:2013
Bending resistance	NPD	EN 14509:2013
Reaction to fire	A2-s1-d0	EN 13501-1:2007
Fire resistance	EI20/E120	EN 13501-2:2007
Fire protection capability	NPD	EN 14509:2013
Thermal resistance	0.96 m <sup>2</sup> K/W	EN 14509:2013
Permeability of water	NPD	EN 12865
Air permeability	NPD	EN 11214
Vapor permeability	NPD	EN 14509:2013
Airborne sound insulation	34 Rw	ISO 140-3:95
Sound absorption	NPD	EN ISO 11654
Dimensional stability	PASS	EN 14509:2013
Durability	PASS	EN 14509:2013

Tolerans	Core material	Surface material
Length: ± 5 mm Width: ± 1 mm Thickness: +0/-1 mm Perpendicularity: 1 mm/m Surface roughness: +0/-0.35 mm	Material: Mineral wool Density: 180 kg/m <sup>3</sup> ±10%	Material: Hot dip galvanized steel sheet Thickness: 0.7/0.7mm

Signed on behalf of the manufacturer:  
Överkalix 2024-03-04*Michael Ottesen Fossen*Michael Ottesen Fossen  
Isolamin Sweden AB  
R&D Technician / Project coordinator